

भारत सरकार



दूरभाष- 0712-2510156

ई-मेल: wgdivision@yahoo.co.in

No. WD/NAG/HQJE/JE-34/2016-17/45-48

वैनगंगा प्रभाग, केन्द्रीय जल आयोग

दूसरी मंजिल, ब्लाक- सी. सी. जी. ओ. कॉम्प्लेक्स

सेमिनरी हिल्स नागपुर- 440006

Dated: 27/02/2017

NOTICE INVITING QUOTATION

Sealed quotations are hereby invited from registered firms/reputed parties to carry out the following works as per the terms and conditions described below:

Sl No.	Description of works	Quantity	Estimated cost	Time of completion
1.	Civil Work for Construction of Laboratory work platform at Wainganga Division, CWC, Nagpur	As per enclosed schedule	Rs.67700/-	15 days

Terms and conditions:

1. The rates must be quoted for each item separately.
2. The rates should be inclusive of all taxes. No extra payment on any account will be made.
3. The work should be completed as per the drawing and specifications, otherwise liable for rejection.
4. Income tax as per prevailing rates will be deducted at source. PAN no. must be informed for submission of TDS return to I.T.Deptt.
5. Pre-receipted bill in triplicate as per actual quantity of work will have to be submitted for making payment after satisfactory completion of the work.
6. Payment will be made by Cheque / Demand Draft.
7. Earnest money deposit of Rs.1360/- in the form of Demand Draft payable in favour of Ex.Engr.Wainganga Dn.CWC Nagpur should be enclosed alongwith the quotation.Quotations without required EMD will not be considered and rejected.

Sealed quotation duly super scribed " **Civil Work for Construction of Laboratory work platform at Wainganga Division, CWC, Nagpur**" will be received by the undersigned till 15.00 hours of 06.03.2017 and will be opened on the same day at 15.30 hours in the presence of parties. Quotations received after the schedule time of opening will not be considered. The undersigned reserves the right to reject any or all the quotations without assigning any reasons thereof.

(Signature)

(Ajay Banode)
Executive Engineer

Copy to :-

1. The Accounts branch, WD,CWC,Nagpur.
2. Work order file.
3. Office Notice Board.
- ✓ 4. CWC, Tender Portal.

SCHEDULE OF ITEMS & QUANTITY

Name of Work: Construction of Laboratory work platform at Wainganga Division, CWC, Nagpur

Item No.	Description of item	Unit	Qty.	Rate	Amount
1	Removing old tiles works of laboratory work tables	Job	2		
2	Providing and fixing 18 mm thick gang saw cut, mirror polished, premoulded and prepolished, machine cut for kitchen platforms, vanity counters, window sills, facias and similar locations of required size, approved shade, colour and texture laid over 20 mm thick base cement mortar 1:4 (1 cement : 4 coarse sand), joints treated with white cement, mixed with matching pigment, epoxy touch ups, including rubbing, curing, moulding and polishing to edges to give high gloss finish etc. complete at all levels. Area of slab over 0.50 sqm 1. New work platform 2. Old work platform 3. Microbiology lab platform	Sqm sqm sqm	5.87 5.86 3.84		
3	Providing and fixing 30 mm thick Kadappa stones complete. 1. New work platform 2. Micro biology lab platform	sqm sqm	1.52 0.3		
4	Providing & fixing ceramic kitchen sink with C.I brackets & stateless steel plug 40 mm, including fitting and brackets, cutting & making good the walls wherever required of size 600x450x200 mm	No.	1		
5	Providing and fixing C.P brass 3 outlet stop cock of standard design and approved quality of 15 mm nominal bore as per specification on Engineer in charge.	No.	1		
6	Extra for providing opening of required size & shape for wash basin/ kitchen sink in kitchen platform, vanity counter and similar location in marble/ Granite/ stone work, including necessary holes for pillar taps etc. including moulding, rubbing and polishing of cut edges etc. complete.	No.	1		
7	Semi Rigid PVC waste pipe for sink and wash basin 40 mm dia with length not less than 700 mm i/c PVC waste fittings	m	5.6		
8	Providing and fixing GI pipe of 15 mm dia, complete.	m	5.6		
9	Providing and fixing 1st quality ceramic glazed wall tiles conforming to IS: 15622 (thickness to be specified by the manufacturer), of approved make, in all colours, shades except burgundy, bottle green, black of any size as approved by Engineer-in-Charge, in skirting, risers of steps and dados, over 12 mm thick bed of cement mortar 1:3 (1 cement : 3 coarse sand) and jointing with grey cement slurry @ 3.3kg per sqm, including pointing in white cement mixed with pigment of matching shade complete. 300x300 mm	sqm	1.75		
10	Other miscellaneous work like drilling hole in wall for wash basin drainage pipeline, water supply pipe, L Plate etc. with all labour charges complete.	Job	1		
Total					

(Rupees _____)

Signature Of Contractor

Name of Work - Construction of Laboratory Work platform at Waingang Division, CWC, Nagpur.

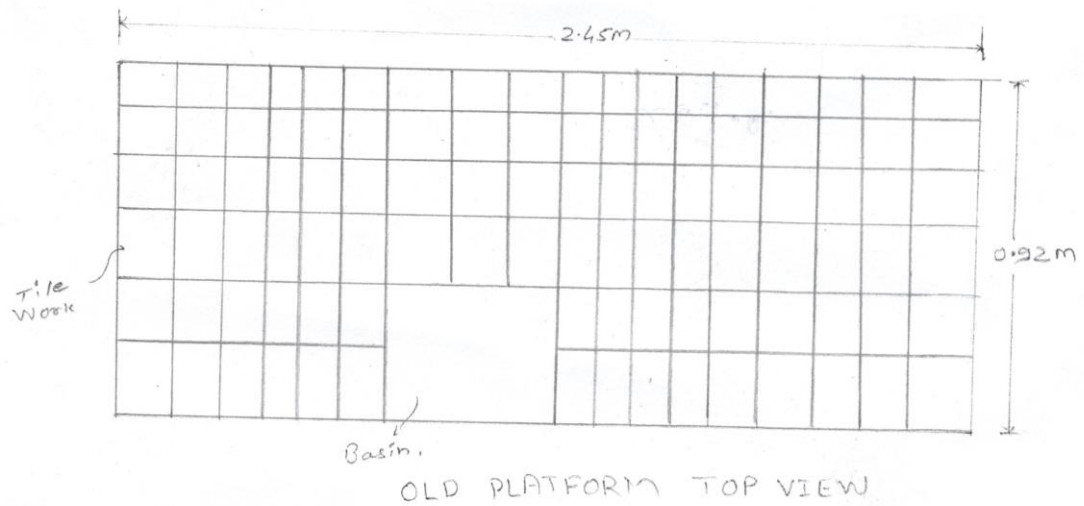
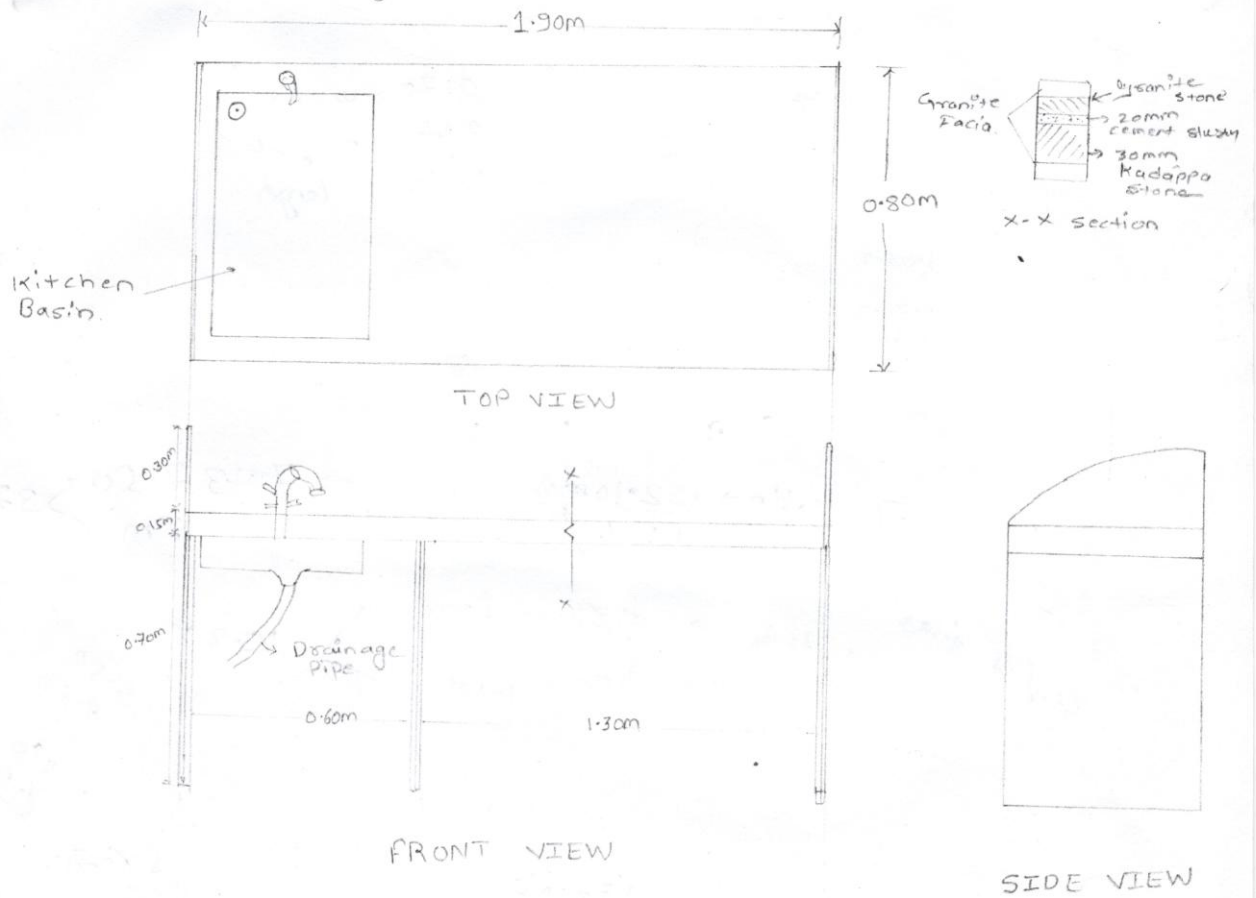

NOT AS PER SCALE