



भारत सरकार

Government of India

जल संसाधन, नदी विकास एवं गंगा संरक्षण मंत्रालय

Ministry of Water Resources, River Development & Ganga Rejuvenation

उपमंडलीय अभियन्ता का कार्यालय  
साबरमती उप मंडल  
केन्द्रीय जल आयोग  
अहमदाबाद



Office of The Sub Divisional Engineer  
Sabarmati Sub Division  
Central Water Commission  
Ahmedabad

NIQ NO.:SSD/ABAD/NIQ/2016-17/10

दिनांक :

| 11 | 16

### Notice Inviting Quotations

Sealed quotations are invited for the work of “Construction of Boundary wall & MTBM at site,Una” on behalf of President of India by this office from the reputed firms / contractor as per the enclosed schedule of quantity (annexure-1) and terms & conditions given below:-

#### Terms & Conditions:

1. The sealed quotation should reach this office latest by **15.00 Hrs. on or before 28/11/2016** and the same will be opened on the same day at 15.30 Hrs. in presence of the bidders or representative thereof, if any.
2. The sealed cover should be super scribed with words “Construction of Boundary wall & MTBM at site,Una”.
3. Rates for each item shall be furnished in the format as given above in the schedule of quantity. Any correction, overwriting shall be countersigned.
4. The Rate shall be quoted in figure as well as in words.
5. The offer rate must remain **valid for a period of Ninety (90) days** from the date of opening of quotation.
6. Quotations erased and over written will be summarily rejected unless corrections are authenticated with bidder's signature.
7. Sales tax or any other tax on materials in respect of this contract shall be payable by the contractor and department shall not entertain any claim whatsoever in this respect.
8. Taxes as applicable will be deducted at the source from the bill at the time of payment.
9. **The whole work should be completed within 45 days from the date of issue of order.**
10. **Earnest Money Deposit (EMD) amounting to Rs. 3570/- (Rupees three thousand five hundred seventy) only should be deposited** along with the quotation in the form of Cash receipt (if deposited in cash) / DD of a scheduled bank in favour of the Executive Engineer, Mahi Division, CWC, Gandhinagar (Gujarat) payable at State Bank of India, Gandhinagar Branch, Gandhinagar. For unsuccessful quotationers EMD shall be refunded. EMD shall be forfeited, if any quotationer withdraws their offer before the expiry of the validity period or fails to furnish the performance guarantee / complete the work within the stipulated period from the date of order. **In case of non submission of EMD, the offer will be liable for rejection.**

P.T.O.

11. **Performance Guarantee will be submitted with in seven (7) days by successful quotationers for 5% value of the ordered price** claimed by the “Contractor” to cover the standards of performance. The performance guarantee for 5% value may be furnished in the form of A/c payee demand draft from of a scheduled bank in favour of the Executive Engineer, Mahi Division, CWC, Gandhinagar (Gujarat) payable at State Bank of India, Gandhinagar Branch, Gandhinagar. The Performance Guarantee shall be refunded to the contractor soon after completion of the work and recording of the completion certificate.
12. **Security deposit @ 5% of the gross amount of bill shall be deducted** from the final bill of the contractor. The above “Security deposit” shall be refunded after completion of all guarantee / warranty obligation.
13. **The whole work shall be guaranteed for a period of 6 (six) months from the date of actual completion as recorded.** The work should be completed satisfactorily and in all respects as directed by this office. In the event of any defect is found within the guaranteed period due to faulty design or bad workmanship, the whole work or a part thereof will be replaced by the “Contractor” at site free of cost within 10 days of intimation.
14. A copy of proof of registration / PAN no. may be submitted along with their offer.
15. The work site can be inspected by the contractor between 14.00 Hrs to 17.00 Hrs. on any working days except Saturday, Sunday & holidays at Sabarmati Sub Division,CWC,Ahmedabad (Gujarat)
16. The material used in the works should be of good quality and free from defect and if found not suitable the same should be replaced by the contractor at his own cost & risk.
17. The work should be carried out / completed as per the specification mentioned in the work order. If found not satisfactory according to the specification, the same should be dismantled immediately at the own cost & risk of the Contractor for which no claim will be entertained by this department.
18. The quantity will be decreased or increased at the time of work order for which the contractor should bind to execute the works.
19. This office reserves the right to reject any or all the quotations and to alter the quantity without assigning any reasons.
20. Intimation of unsuccessful quotation will not be given to concerned firms and the quotationers shall have no claim of any nature on this office.
21. Canvassing in any form whether directly or indirectly is strictly prohibited.
22. In case of any disputes arises, the decision of the undersigned will be final and binding on the Contractor.
23. The department will not be responsible for any injury sustained to the workers during the performance of their duties on the work and also any damage or compensation due to any disputes between the Contractor and the workers.
24. **No advance payment would be made under any circumstances.** However, after satisfactory completion of the work, on receipt of the bill in triplicate payment shall be made by A/c payee Cheque payable at SBI, Gandhinagar.
25. Any other rules & codes of CPWD and its amendment as applicable will be binding on the successful bidder for this deal.

Signature of the Contractor with seal

-----sd-----  
Sub Divisional Engineer

**Name of Work:-“ Construction of Boundary wall & MTBM at site,Una”.**

**NIQ NO.:-SSD/ABAD/NIQ/2016-17/10 dated 17 /11/16**

Sl. No	Description of item	Unit	Qty	Rate (Rs Ps.)	Amount (Rs Ps.)
<b>A</b>	<b>Construction of Boundary wall at site,Una</b>				
1	Dismantling stone rubble masonry manually/by mechanical means including stacking of serviceable material and disposal of unserviceable material within 50 meters lead as per direction of engineer in charge: In cement mortar. (Existing Boundary Wall)	Cum	2.160		
2	Clearing jungle including uprooting of rank vegetation,grass,brush,wood,trees and saplings of girth upto 30 cm measured at a height of 1 m above the ground level and removal of rubbish upto a distance of 50 m outside the periphery of the area cleared.	Sqm	365.09		
3	Earth work in excavation by mechanical means(Hydraulic Excavator)/manual means over areas ( exceeding 30 cm in depth but exceeding 1.5 m in width as well as 10 sqm on plan) including disposal of excavated eart,lead upto 50 m and lift upto 1.5 m, disposed soil to be levelled and neatly dressed : 2.6.1 All kinds of soil	Cum	14.563		
4	Providing and laying in position cement concrete of specified grade excluding the cost of centering and shuttering - All work up to plinth level : 1:4:8 (1 Cement : 4 coarse sand : 8 graded stone aggregate 40 mm Nominal Size	Cum	1.928		
5	Centering and shuttering including strutting, propping etc. and removal ofform for :Columns, Pillars, Piers, Abutments, Posts and Struts.	Sqm	35.57		
6	Reinforced cement concrete work in walls (any thickness), includingattached pilasters, buttresses, plinth and string courses, fillets, columns,pillars, piers, abutments, posts and struts etc. up to floor five level,excluding cost of centering, shuttering, finishing and reinforcement : 5.2.3 1:2:4 (1 cement : 2 coarse sand : 4 graded stone aggregate 20mm nominal size	Cum	3.189		
7	Steel reinforcement for R.C.C. work including straightening, cutting,bending, placing in position and binding all complete upto plinth level.5.22.1 Mild steel and Medium Tensile steel bars (8000 Kg/Cum)	Kg	255.12		

8	Coursed rubble masonry (second sort) with hard stone in foundation and plinth with Cement mortar 1:6 (1 cement :6 coarse sand)	Cum	5.057		
9	Coursed rubble masonry with hard stone( first or second sort) in superstructure above plinth level and upto floor five level with Cement mortar 1:6 (1 cement :6 coarse sand)	Cum	10.627		
10	12 mm cement plaster of mix : 1:4 (1 cement: 4 fine sand)	Sqm	106.24		
11	White washing with lime to give an even shade : 13.37.1 New work (three or more coats)	Sqm	106.24		
<b>B</b>	<b>Construction of MTBM at site,Una</b>				
1	Excavation for foundation up to 1.5m depth including sorting out and stacking of useful materials and disposing of the excavated stuff up to 50 m lead of hard murram for foundation	Cum	2.496		
2	Providing and laying ordinary cement concrete 1:2:4 (1 cement , 2 coarse sand and 4 graded stone aggregate 20mm nominal size) with curing etc., complete excluding the cost of formwork in foundation & Plinth	Cum	2.489		
3	Brick work using common burnt clay building bricks having crushing strength not less than 35kg per sqm in Superstructure up to floor 2 level in cement mortar 1:5 of conventional bricks	Cum	0.863		
4	Providing 15mm thick cement plaster in single coat on brick / concrete walls for interior plastering up to floor 2 level and finished even and smooth in cement mortar 1:4 (one cement and 4 sand)	Sqm	8.750		
5	Providing and fixing white stone plate of size (0.1x0.1x1.0)m Granite on wall at Top.	No.	1.000		
6	Providing and fixing white stone plate of size (0.3x0.2x0.02)m on wall	No.	1.000		
7	Filling available excavated earth (excluding rock) in trenches,plinth,sides of foundation etc. in layers not exceeding 20 cm depth consolidating each deposited layer by ramming and watering.	Cum	0.598		
8	White wash with lime on wall surface (two coats) to even shade including thoroughly brooming the surface to remove all dirt,dust, mortar drop and other foreign matters	Sqm	8.750		
	<b>Grand Total</b>				

(Rupees

We agree to execute the above works in accordance with the technical specifications and terms & conditions mentioned in NIQ NO.:-SSD/ABAD/NIQ/2016-17/10 dated 17.11.2016 for a total contract price of Rs..... (Rupees.....) within the period specified in the NIQ.

**Place:**

**Date:**

**Signature of Contractor  
Address**

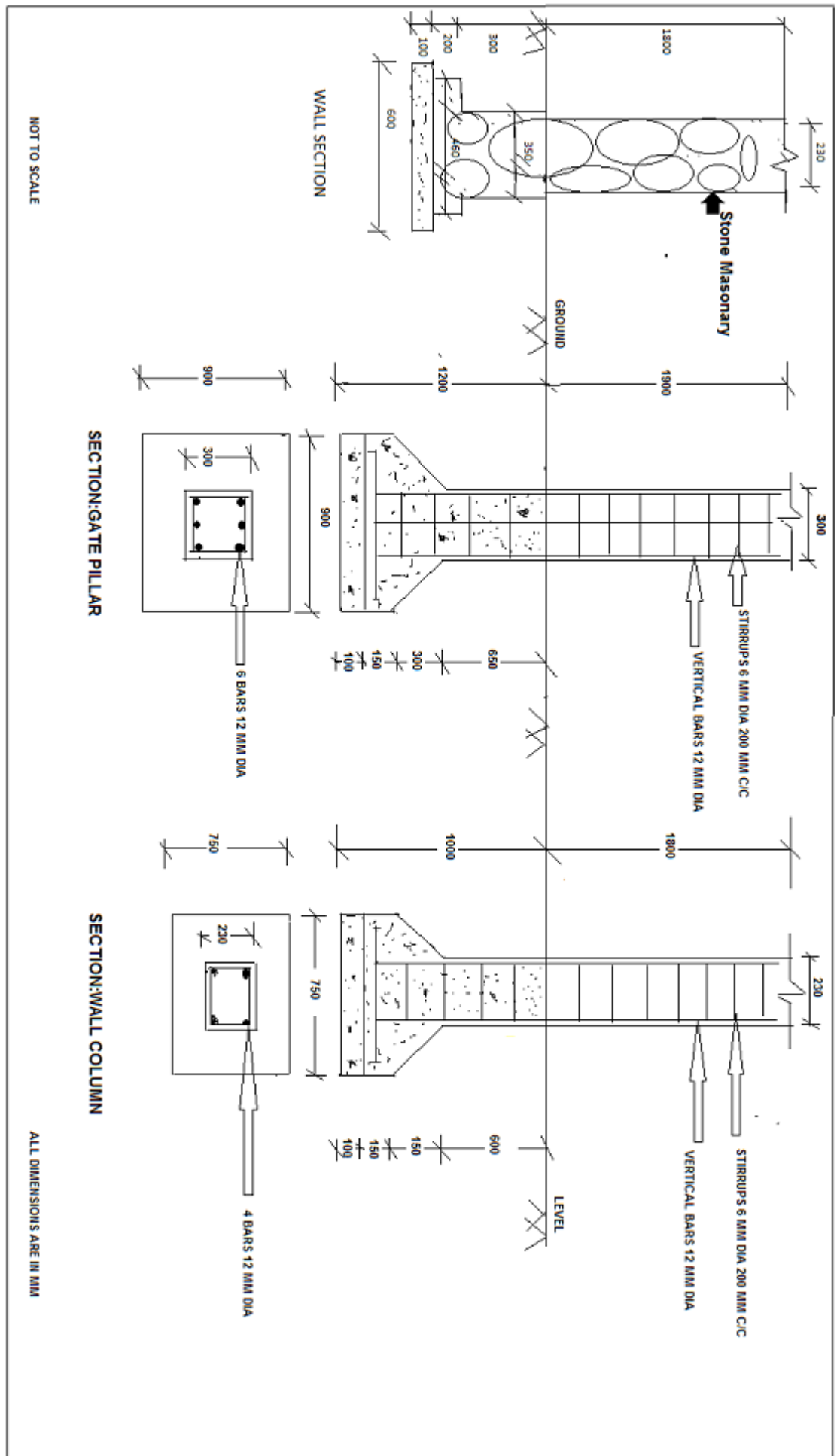

Drawing-1

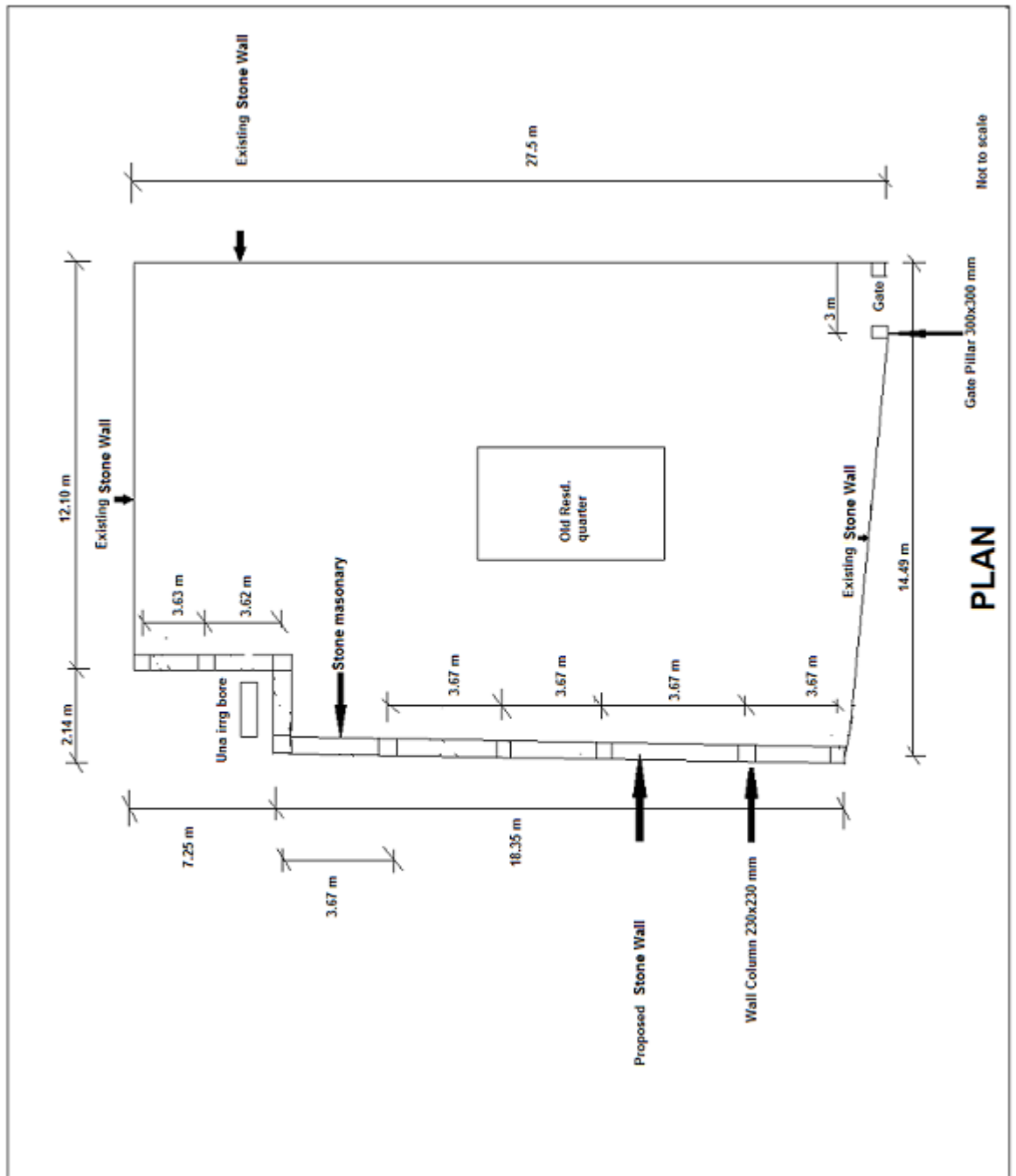

Drawing-2

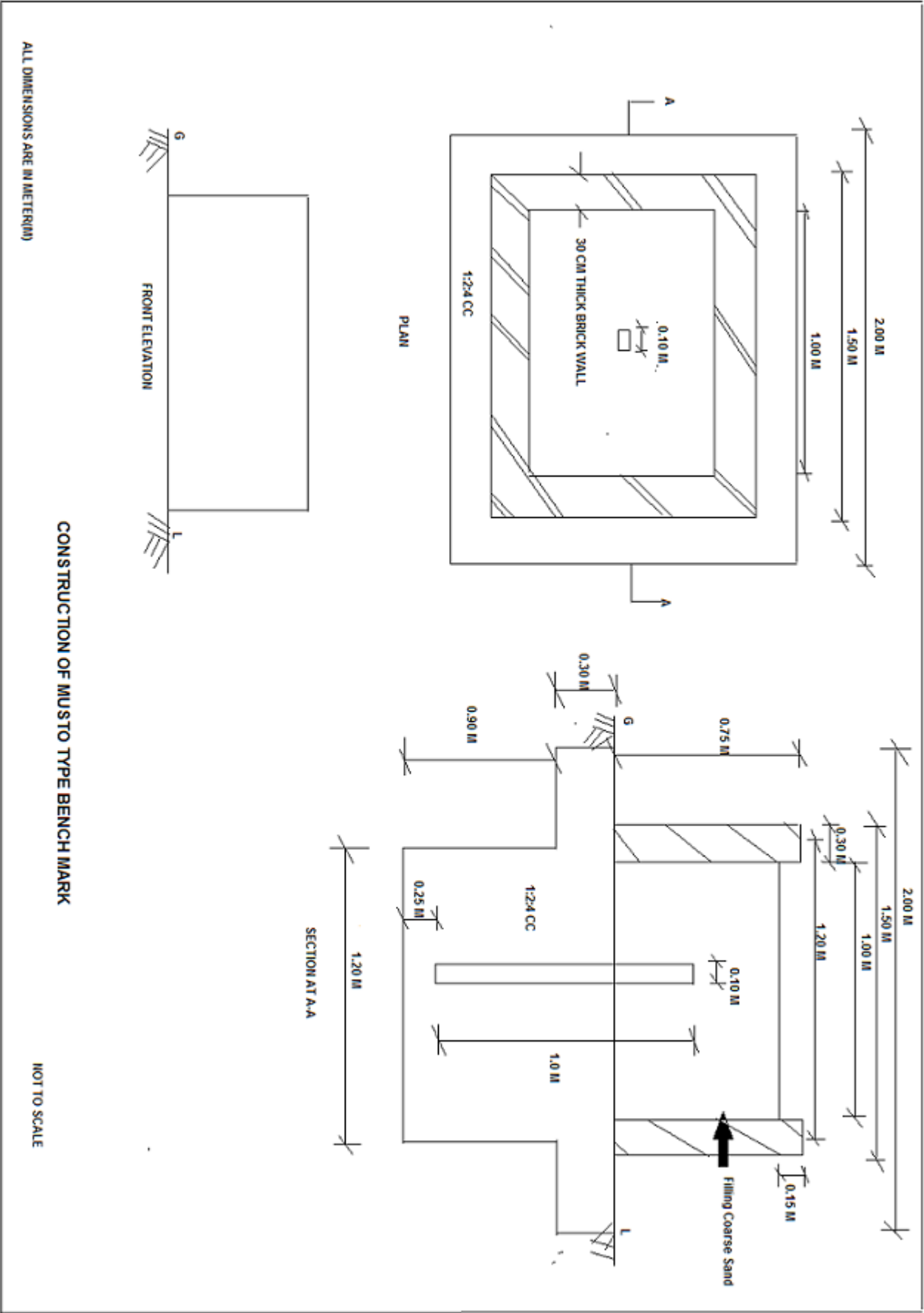

Drawing-3