

BILL OF QUANTITY

Name of work: R&M Estimate for Repairing of Toilet Block, Silt Room Platform and Plywood ceiling of Site office Hiwra under PGSD,CWC,Yavatmal

Division: Wainganga Division, CWC, Nagpur.

S. No	Description of work	Qty.	Unit	Rate	Amount (Rs)	
					In fig.	In words
1.	Repairing Of Toilet block					
a	Demolishing cement concrete manually/ by mechanical means including disposal of material within 50 metres lead as per direction of Engineer - in - charge. Nominal concrete 1:3:6 or richer mix (i/c equivalent design mix)	0.93	cum			
b	Chipping of unsound/weak concrete material from slabs, beams, columns etc. with manual Chisel and/ or by standard power driven percussion type or of approved make including tapering of all edges, making square shoulders of cavities including cleaning the exposed concrete surface and reinforcement with wire brushes etc. and disposal of debris for all lead and lifts all complete as per direction of Engineer-In-Charge 25 mm average thickness	19.390	sqm			
c	Providing and laying in position cement concrete of specified grade excluding the cost of centering and shuttering – All work up to plinth level ::1½:3 (1 Cement: 1½ coarse sand (zone-III) : 3 graded stone aggregate 20 mm nominal size)	0.93	cum			
d	Providing and laying Vitrified tiles in different sizes (thickness to be specified by the manufacturer), with water absorption less than 0.08% and conforming to IS: 15622, of approved brand & manufacturer, in all colours and shade, in skirting, riser of steps, laid with cement based high polymer modified quick set tile adhesive (water based) conforming to IS: 15477, in average 6 mm thickness, including grouting of joints (Payment for grouting of joints to be made separately). Size of Tile 500x500 mm	6.2	sqm			
e	Tile work in skirting, risers of steps and dado up to 2 m height over 12 mm thick bed of cement mortar 1:3 (1 cement :3 coarse sand) and jointed with grey cement slurry @ 3.3 kg/sqm, including pointing in white cement mixed with pigment of matching shade complete. 11.22.1.1 8 mm thick	19.390	sqm			
f	Providing and fixing white vitreous china pedestal type water closet (European type W.C. pan) with seat and lid, 10 litre low level white P.V.C. flushing cistern, including flush pipe, with manually controlled device (handle lever), conforming to IS : 7231, with all fittings and fixtures complete, including cutting and making good the walls and floors wherever required : W.C. pan with ISI marked white solid plastic seat and lid	1	Each			
g	Providing and fixing wash basin with C.I. brackets, 15 mm C.P. brass pillar taps, 32 mm C.P. brass waste of standard pattern, including painting of fittings and brackets, cutting and making good the walls wherever require: White Vitreous China Wash basin size 630x450 mm with a pair of 15 mm C.P. brass pillar taps	2	Each			
h	PTMT Pillar cock (fancy) 15 mm foam flow	4	Each			
i	Providing and fixing Chlorinated Polyvinyl Chloride (CPVC) pipes, having thermal stability for hot & cold water supply, including all CPVC plain & brass threaded fittings, including fixing the pipe with clamps at 1.00 m spacing. This includes jointing of pipes & fittings with one step CPVC solvent cement and testing of joints complete as per direction of Engineer in Charge. 20 mm nominal outer dia Pipes for gardening washroom and silt room	32	meter			
j	Providing and fixing PTMT towel rail complete with brackets fixed to wooden cleats with CP brass screws with concealed fittings arrangement of approved quality and colour.	1	Each			

	600 mm long towel rail with total length of 645 mm, width 78 mm and effective height of 88 mm, weighing not less than 190 gms.					
k	Providing and fixing mirror of superior glass (of approved quality) and of required shape and size with plastic moulded frame of approved make and shade with 6 mm thick hard board backing Rectangular shape 1500x450 mm	1	Each			
2	Construction of platform for silt lab and plywood Ceiling					
a.	Brick work with common burnt clay machine moulded perforated bricks of class designation 12.5 conforming to IS: 2222 in superstructure above plinth level up to floor five level in cement mortar 1:6 (1 cement : 6 coarse sand) :With F.P.S.(non modular) bricks	0.259	cum			
b.	18 mm cement plaster in two coats under layer 12 mm thick cement plaster 1:5 (1 cement : 5 coarse sand) finished with a top layer 6 mm thick cement plaster 1:6 (1 cement : 6 fine sand).	4.845	cum			
c.	Providing and applying white cement based putty of average thickness 1 mm, of approved brand and manufacturer, over the plastered wall surface to prepare the surface even and smooth complete.	4.845	sqm			
d.	Distempering with 1st quality acrylic distemper, having VOC (Volatile Organic Compound) content less than 50 grams/ liter, of approved brand and manufacture, including applying additional coats wherever required, to achieve even shade and colour.	4.845	sqm			
e	Marble stone flooring with 18 mm thick marble stone, as per sample of marble approved by Engineer-in-charge, over 20 mm (average) thick base of cement mortar 1:4 (1 cement : 4 coarse sand) laid and jointed with grey cement slurry, including rubbing and polishing complete Black Zebra	2.250	sqm			
f	Providing and fixing plain lining with necessary screws/nuts & bolts/ nails, including a coat of approved primer on one face, and fixed on wooden /steel frame work, complete as per direction of Engineer-in- charge (Frame work shall be paid for separately). 12mm thick commercial ply conforming to IS : 1328 BWR type	45.140	sqm			
g	Providing wood work in frames of false ceiling, partitions etc. sawn and fixed in position with necessary stainless steel screws etc.Sal wood	0.169	cum			
h	Applying priming coat With ready mixed aluminium primer of approved brand and manufacture on resinous wood and plywood	90.280	sqm			
i	Providing and applying two coats of fire retardant paint on cleaned wood / ply surface @ 3.5 sqm per litre per coat including preparation of base surface as per recommendations of manufacturer to make the surface fire retardant wooden work	90.280	sqm			
j	Providing and fixing aluminium work for doors, windows, ventilators and partitions with extruded built up standard tubular sections/ appropriate Z sections and other sections of approved make conforming to IS: 733 and IS: 1285, fixing with dash fasteners of required dia and size, including necessary filling up the gaps at junctions, i.e. at top, bottom and sides with required EPDM rubber/ neoprene gasket etc. Aluminium sections shall be smooth, rust free, straight, metered and jointed mechanically wherever required including cleat angle, Aluminium snap beading for glazing / panelling, C.P. brass / stainless steel screws, all complete as per architectural	4.488	kg			

	drawings and the directions of Engineer-in-charge. (Glazing, panelling and dash fasteners to be paid for separately Anodized aluminium (anodized transparent or dyed to required shade according to IS: 1868, Minimum anodic coating of grade AC Aluminium frame 20 mm x 20 mm x 3 mm unit weight = 0.44 kg/meter					
k	Providing and fixing glazing in aluminium door, window, ventilator shutters and partitions etc. with EPDM rubber / neoprene gasket etc. complete as per the architectural drawings and the directions of engineer-in-charge. (Cost of aluminium snap beading shall be paid in basic item):	3.930	sqm			
TOTAL AMOUNT						
SAY RS						

(Rupees ----- only)

Signature:-

Name:-

Address:-

Drawing of silt room platform construction at hiwra under PGSD,CWC,Yavatmal

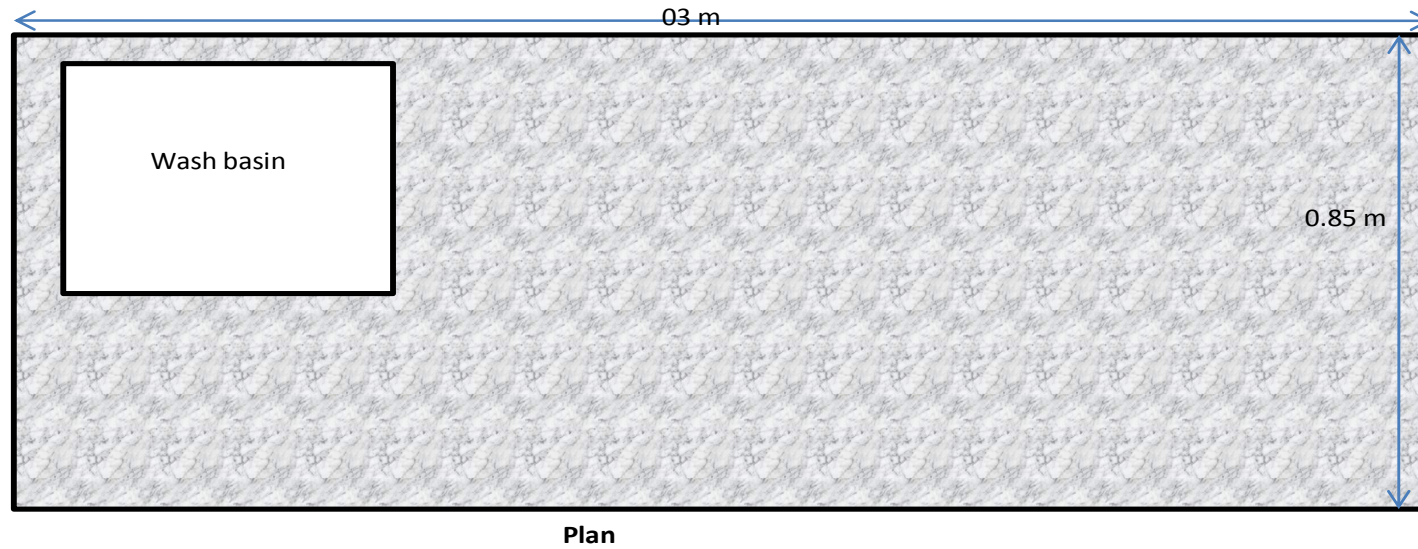
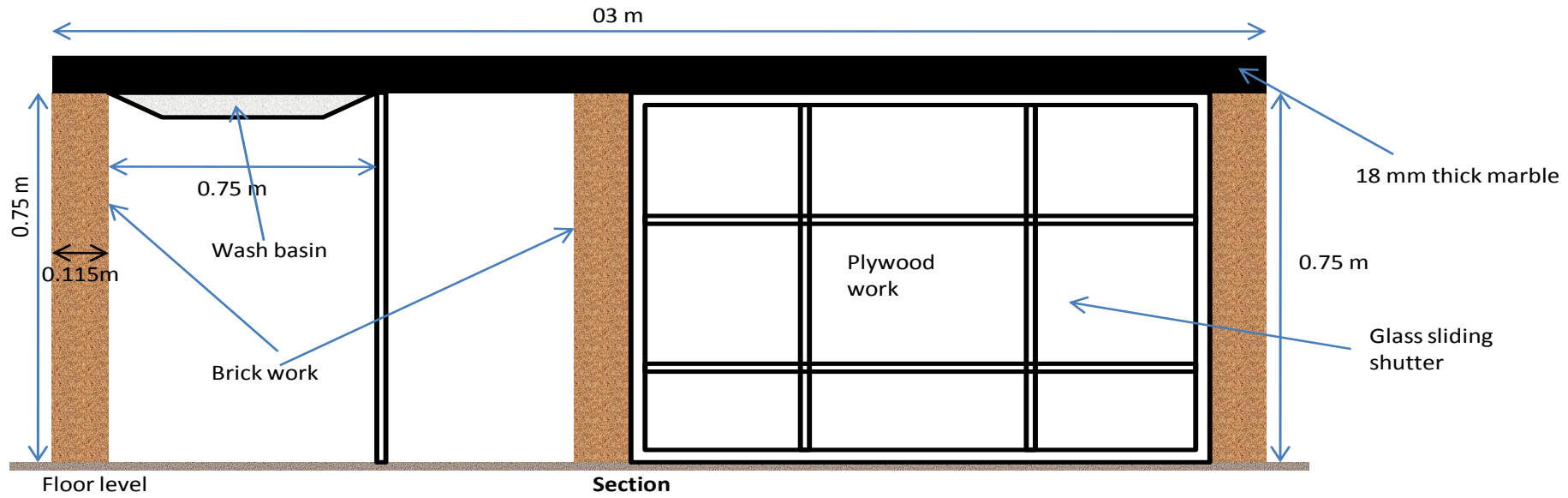

Not to scale

GOVT OF INDIA
CENTRAL WATER COMMISSION
PENGANGA SUB DIVISION

DRAWN BY

CHECKED BY

[Signature]
14/12/2021

[Signature]
14.12.21

DEEPAK KUMAR
JE(HQ)

S.K CHARDE
SDE

Drawing of silt room rack at hiwra under PGSD,CWC,Yavatmal

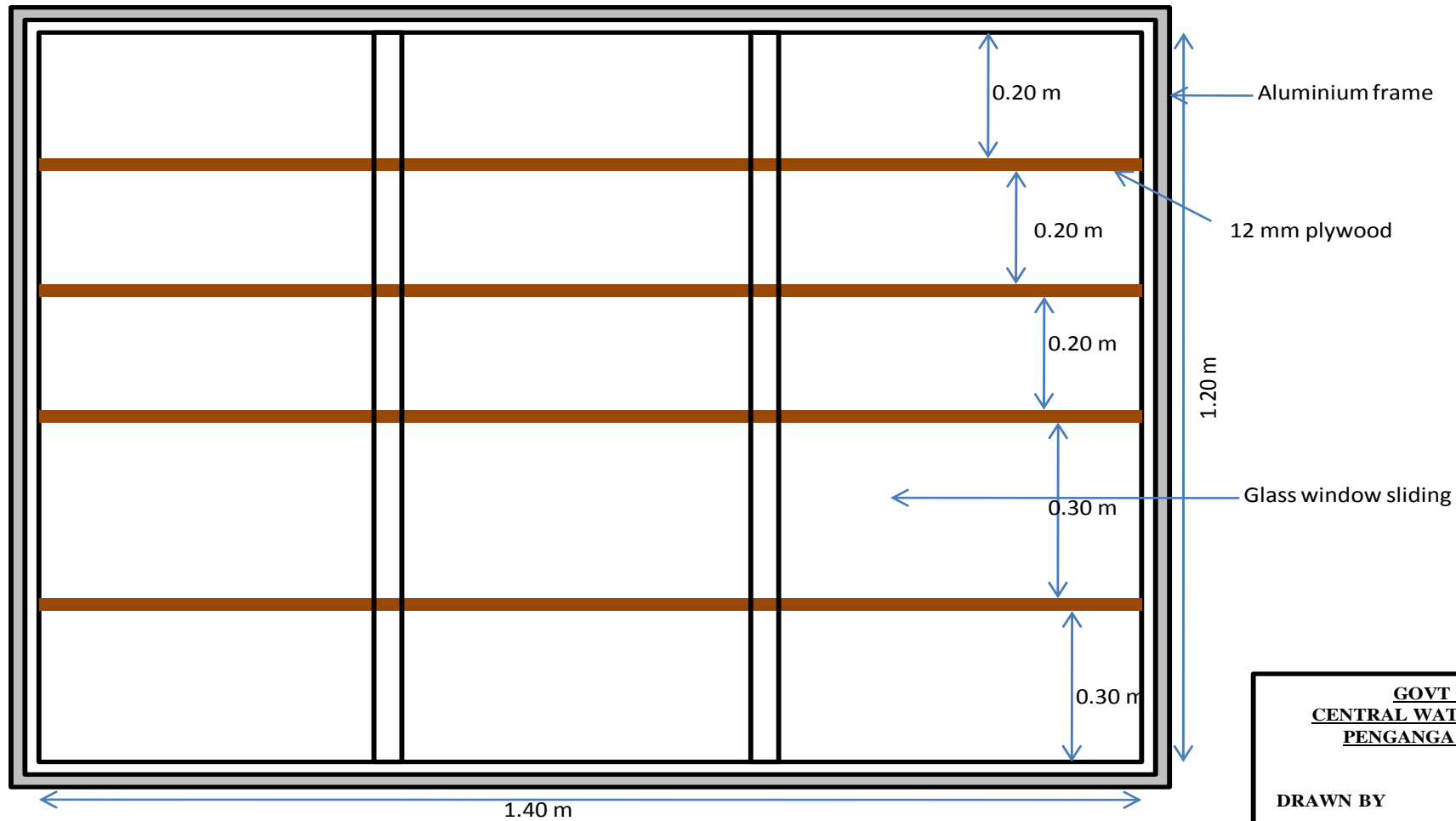

Not to scale

GOVT OF INDIA
CENTRAL WATER COMMISSION
PENGANGA SUB DIVISION

DRAWN BY

CHECKED BY

[Signature]
14.12.2021

[Signature]
14.12.21

DEEPAK KUMAR
JE(HQ)

S.K CHARDE
SDE

Drawing of repairing of toilet block at hiwra under PGSD,CWC,Yavatmal

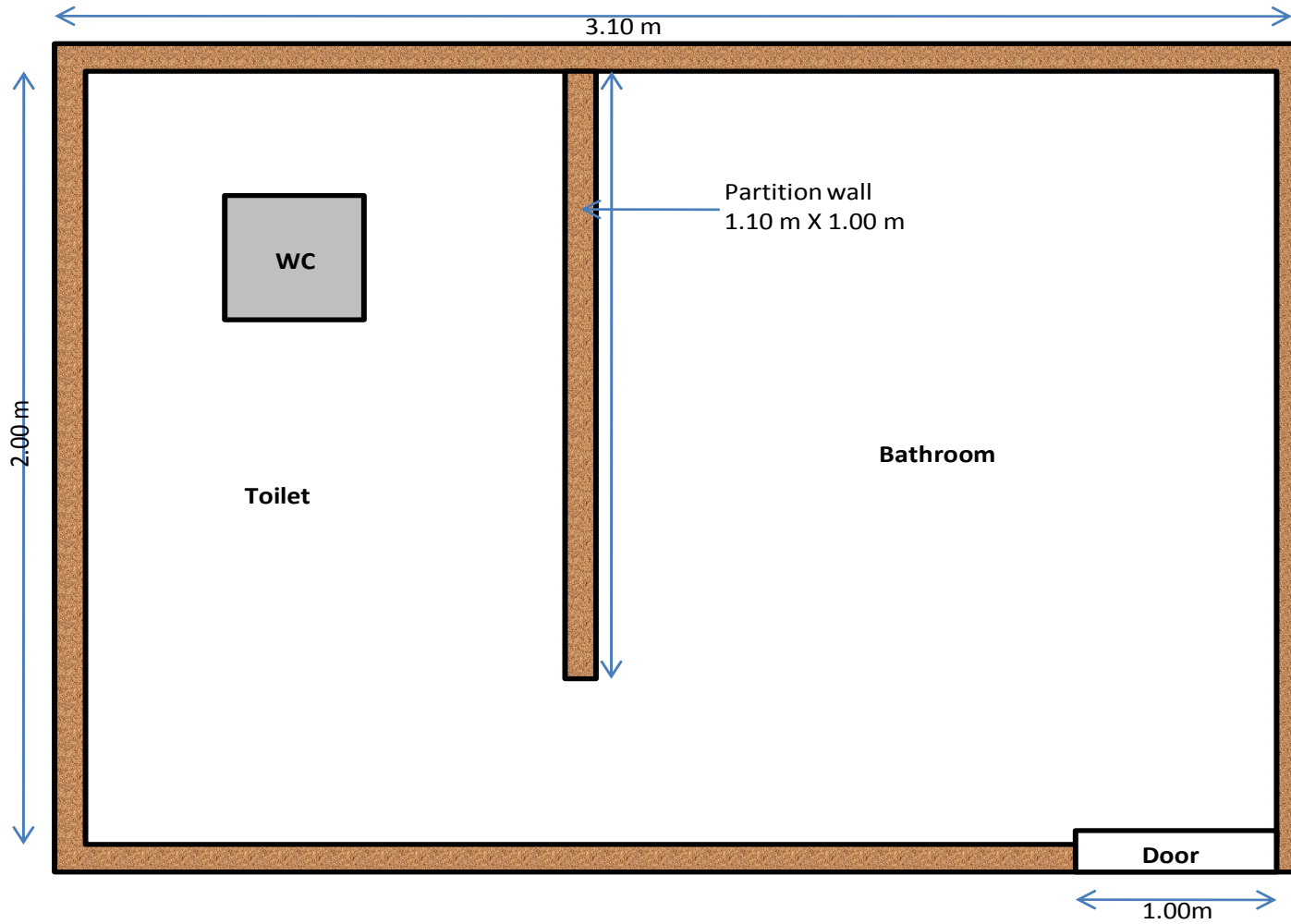

Not to scale

GOVT OF INDIA
CENTRAL WATER COMMISSION
PENGANGA SUB DIVISION

DRAWN BY

CHECKED BY

[Signature]
14.12.2021

[Signature]
14.12.21

DEEPAK KUMAR
JE(HQ)

S.K CHARDE
SDE